

# Hope Chapel & Community Rooms

Our buildings are located on the main road and in the middle of Hebden Bridge. At different times of the week you will find crochet crafts, Brownies, dance classes, a self-help group and other organisations using the rooms. Details are published in 'What's On' area of our website. Nearly £1m has been invested in repairs and restoration work and you will discover information, photographs and artefacts dotted around the place that make this a historic and characterful place for meetings, conferences, concerts and other activities.

The Chapel room provides a venue with an ambience and acoustics like no other building in the town. It has hosted everything from blues and folk festivals to spoken word events and even a Pakistani food masterclass. It also remains an inclusive place for community worship and prayer. The ground floor chapel pews have cushioned covers and the space is equipped with an 18-channel powered mixer, a modest DMX lighting system, a demountable stage and a T-loop hearing system. The main entrance is reached either from a flight of stone steps or via a gently sloping access ramp through the front garden, which is itself an attractive area.

Community rooms are located at the rear of the chapel and accessible from Hope Street via a short ramp. All the ground floor is on the same level, including the toilets, although there is no disabled access to the first floor at present. The main community rooms are equipped with stacking chairs and fold-away tables. Kitchen facilities allow users to provide light refreshments and hot drinks. The toilet block includes a disabled access facility. A partition wall between the Wainsgate and Ebenezer Rooms can be folded back to create a single, large, L-shaped space.

Hope Baptist Church works closely with event organisers and community groups to ensure the facilities are used to promote wholeness and well-being for all and, alongside other venues in the town, contribute to building a sense of community. This means there is flexibility about working arrangements and consideration about activities that are consistent with the church's ethos and make best use of the spaces that are available.

The main chapel building

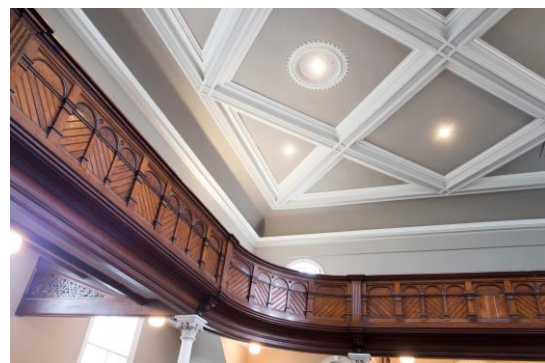

Ebenezer Room (ground floor)



Wainsgate Room (ground floor)



Birchcliffe Room (first floor)



Nazebottom Room (first floor)



Kitchen (ground floor)



Blake Dean (ground floor)



Ground Floor Plans

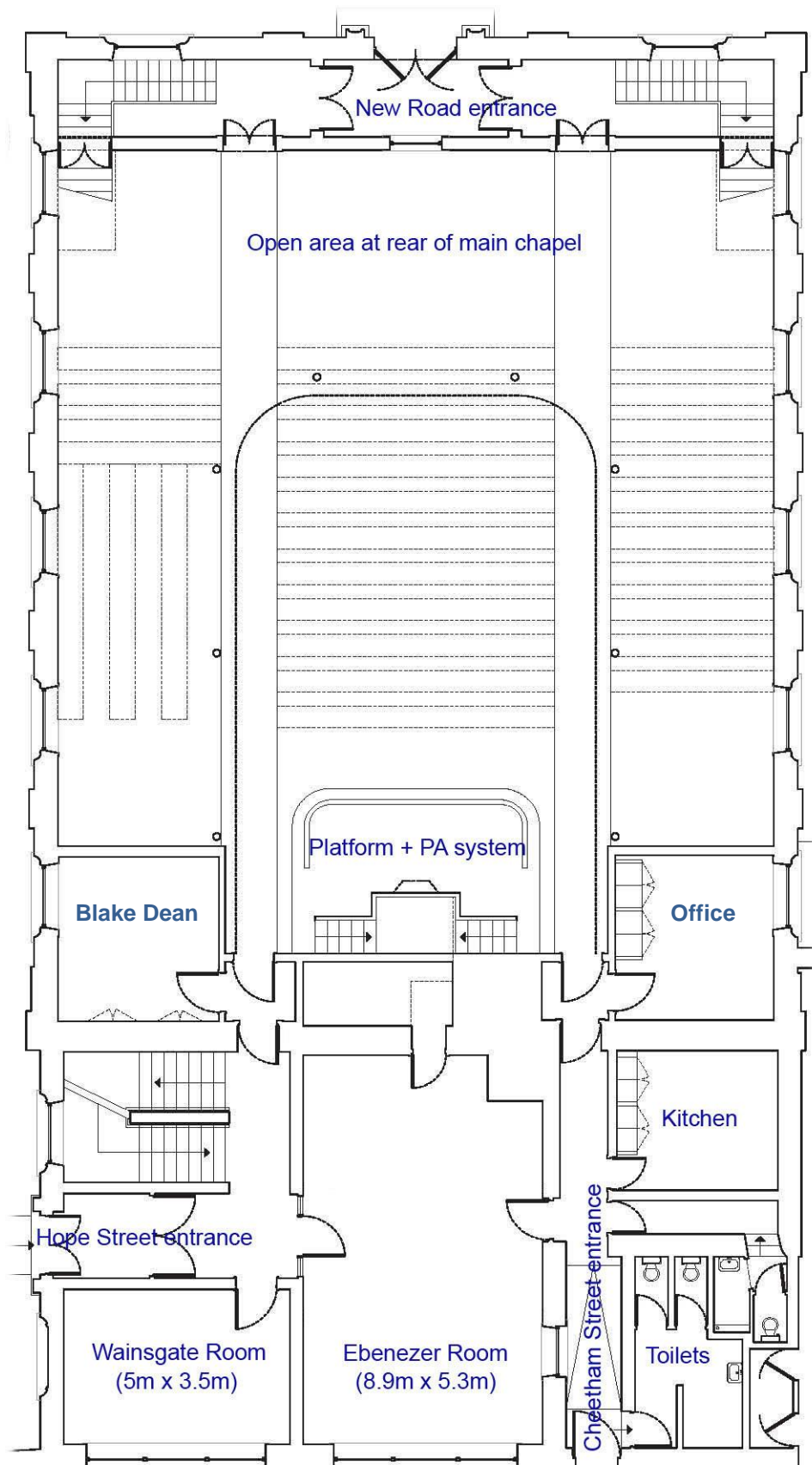

## First Floor Plans

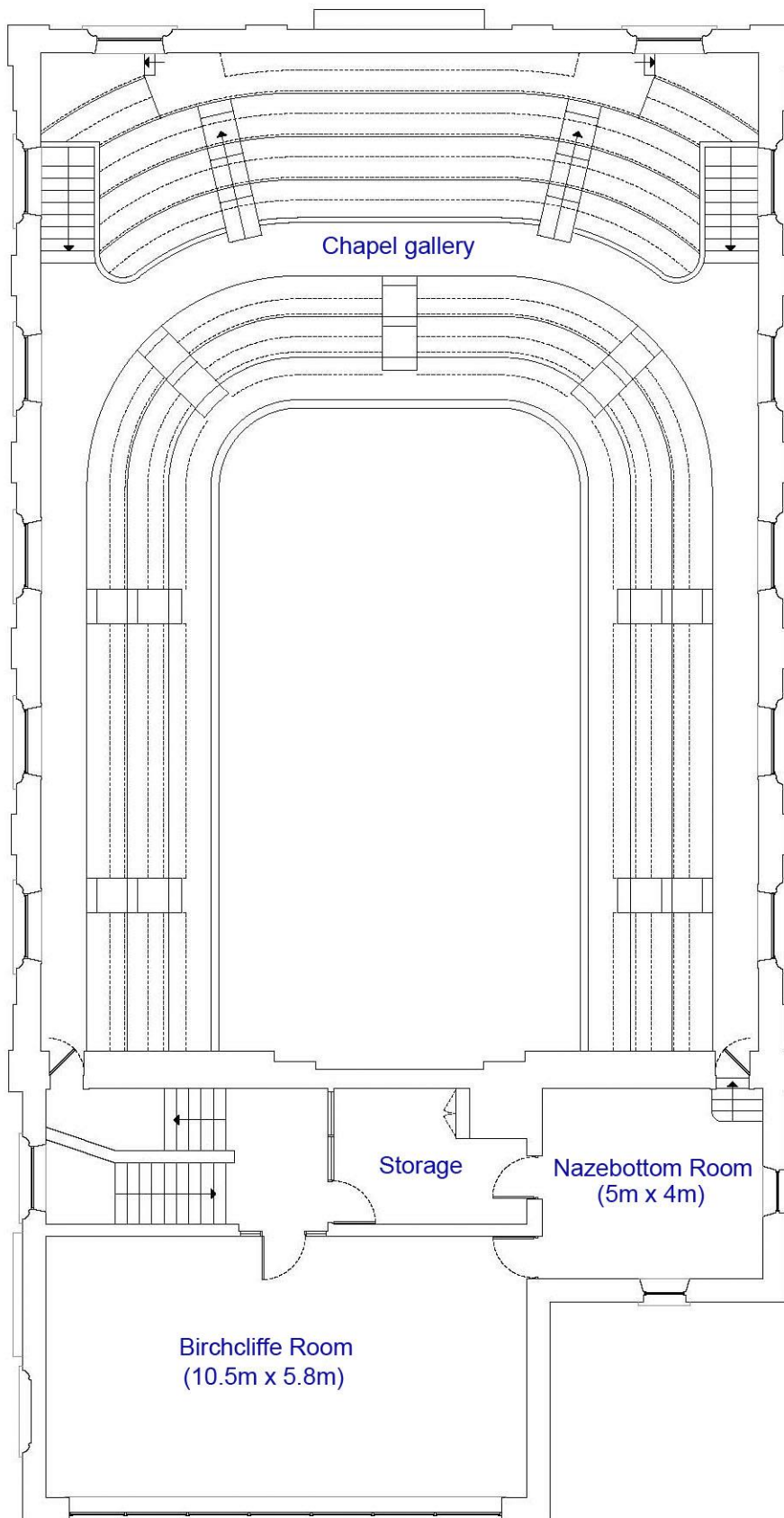

### Community Hire Charges

Our aim is to support community activities, rather than to just make money, from renting the chapel and community rooms. We like to say 'yes' to people who want to use our space for one-off or regular activities. So, please discuss your needs with us.

Ebenezer Room (seating capacity 40)	£14 per hour
Wainsgate Room (meeting room for 8-10)	£12 per hour
Ebenezer + Wainsgate (i.e. partition wall open)	£25 per hour
Birchcliffe Room (capacity 60-70)	£14 per hour
Blake Dean (discussion room for 4-6)	£7 per hour
Nazebottom Room (meeting room for 4-6)	£7 per hour
Main Chapel	Typically £300/full day
18-channel mixer, DMX lighting & elevated stage	Discuss requirements

Block bookings welcomed. 50% deposit normally required.

For more information or to make bookings, contact:

Gerard Liston	<a href="mailto:gerard@objective.uk.com">gerard@objective.uk.com</a>	07973 837 342
Web site	<a href="http://www.hope-baptist.org.uk">www.hope-baptist.org.uk</a>	
Facebook	<a href="https://www.facebook.com/groups/HopeChapelHebdenBridge/">https://www.facebook.com/groups/HopeChapelHebdenBridge/</a>	

