

# Hope Baptist Chapel – Community Rooms

Located right in the middle of Hebden Bridge, with doorways from the chapel onto the main road and from the community rooms onto Hope Street and Cheetham Street, many organisations find this a convenient place to run their activities. At different times of the week, you will find Brownies, Slimmers World, Hebden Bridge Playgroup, Thursday Coffee Morning, the Astronomy Society and others using the rooms.

We've replaced the boiler to provide more reliable heating and refurbished the kitchen. We are also planning an ongoing programme of improvements and remodelling as part of our plans to create the 'John Fawcett Centre', offering a wide range of facilities and activities to the local community.

For the moment, we can provide community rooms at the rear of the chapel, which are accessible from a side entrance on Hope Street (with disabled access from Cheetham Street). The chapel can be used for conferences or public gatherings that need a large capacity.

Each of the rooms is provided with plastic stacking chairs and fold-away tables. Electric supply is limited, but fine for audio/visual equipment and other low wattage items. The premises are supplied with a wireless network, if you require Internet access, and a digital projector, CD player and PA system can be provided, on request.

Regular users are provided with a set of keys, which must be returned at the end of the agreement to use the premises. We also trust all users to return chairs and tables to the sides of the rooms and leave the place with lights switched off, neat and tidy and secure – ready for the next group of users.

## The Chapel



Community Rooms - Ground Floor



Community Rooms – First Floor



Kitchen



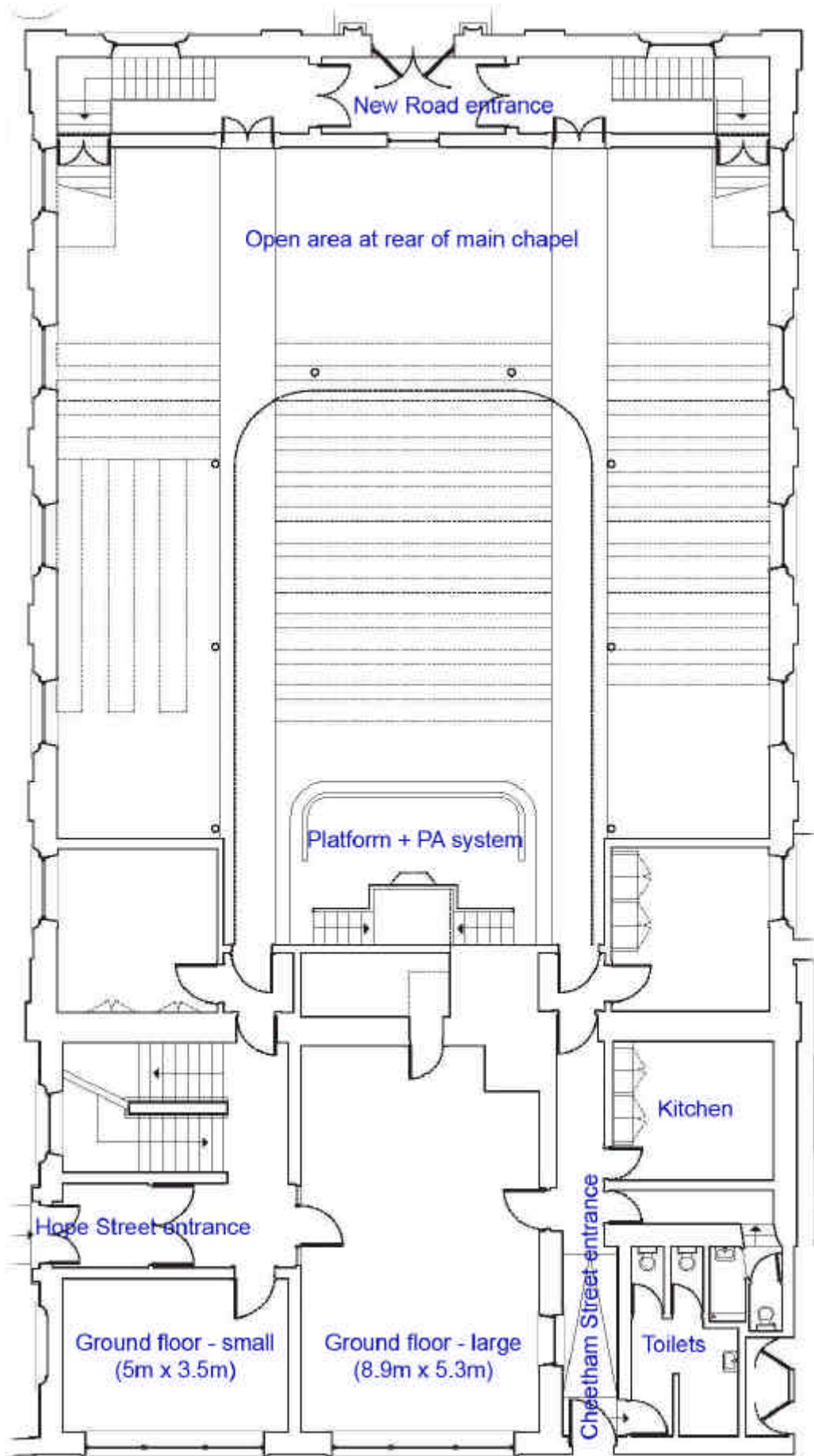

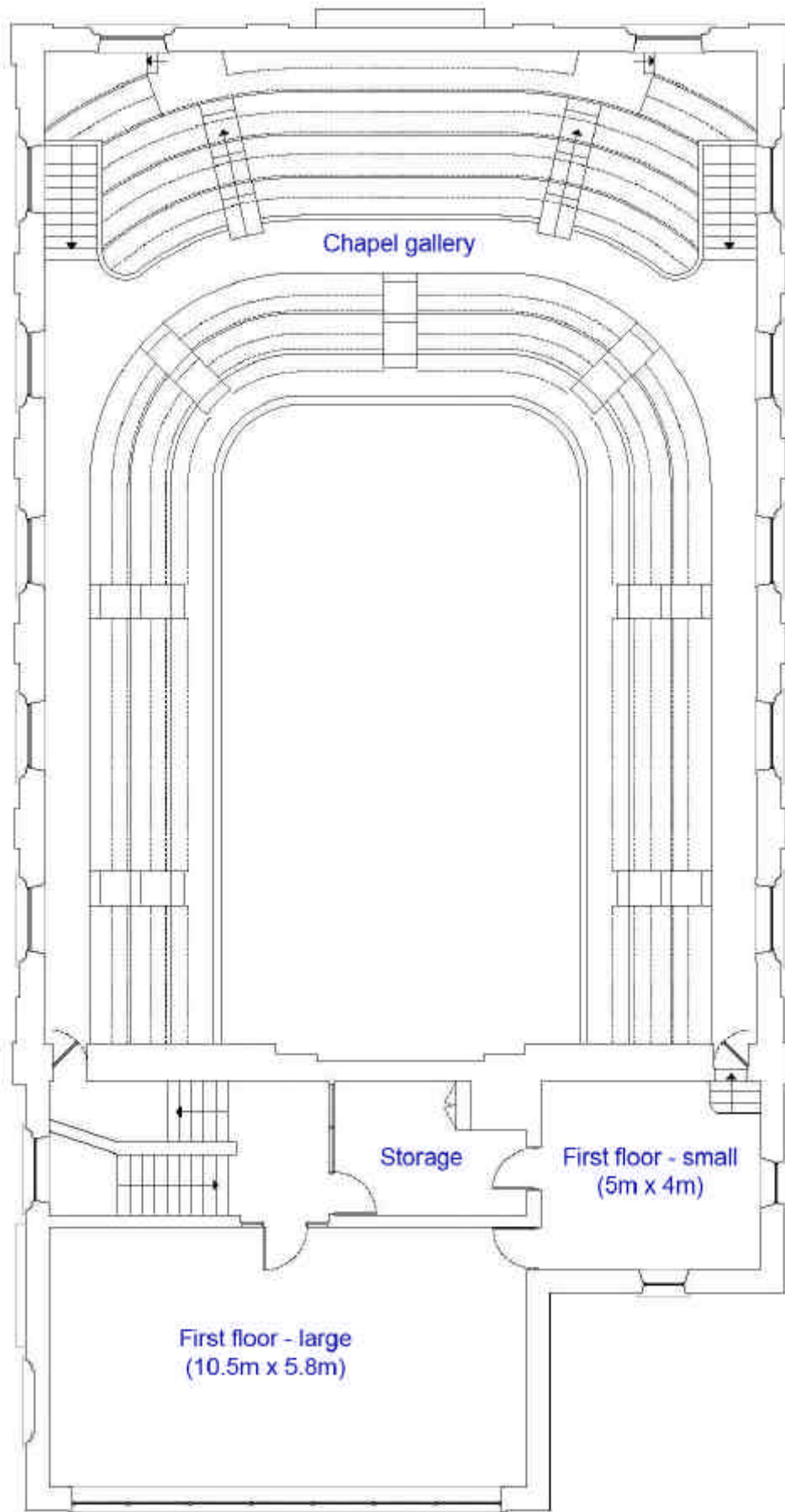

### Hire Charges

Our aim is to support community activities, rather than to make money, from renting the chapel and community rooms. We like to say 'yes' to people who want to use our space for one-off or regular activities.

#### Current charges:

Ground floor (Large room + small room)	£8 per hour (or part)
First floor (large room + small room)	£8 per hour (or part)
Chapel	£20 per hour (or part)
Use of kitchen	additional £2.50 per session
Digital projector/screen + CD player	£5 per session
PA system	£5 per session

For more information or to make bookings, contact:

Marcus Bull	01422 844 006	revmadbull@hotmail.co.uk
Gerard Liston	07973 837 342	gerard@objective.uk.com
Sheila Shackleton		sheilashackleton@talktalk.net
Web site	<a href="http://www.john-fawcett.org.uk">www.john-fawcett.org.uk</a>	